

1

2

3

4

5

6

7

A

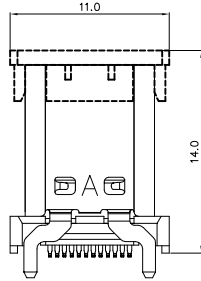
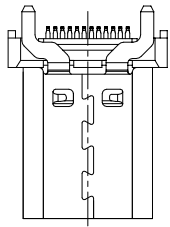

WITH COVER

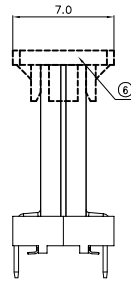

WITH COVER

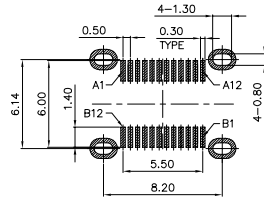

RECOMMEND P.C.B LAYOUT (COMPONENT SIDE)
TOLERANCE FOR PCB LAYOUT IS ± 0.05
KEEP OUT AREA

NOTES:

- 1.ELECTRICAL:
 - 1.1 Contact Resistance: 40 Milliohms Max
 - 1.2 Dielectric Withstanding Voltage : 100V AC for 1 minute
 - 1.3 Insulation Resistance: 100 Megohms Min
- 2.FINISH
 - 2.1 Contact Plating: 1u" Au over Ni on contact area
Matt Tin over Ni on solder area
- 3.MECHANICAL:
 - 3.1 Mating Force: 5-20 N
 - 3.2 Unmating Force: 8-20 N
 - 3.3 Unmating Force: 6-20 N (after test)
 - 3.4 Durability: 10000 Cycles
- 4.Packing: T&R+Cap

B

C

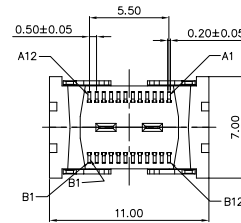
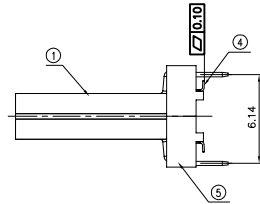
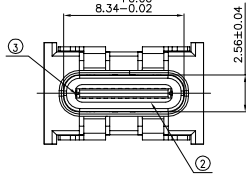

D

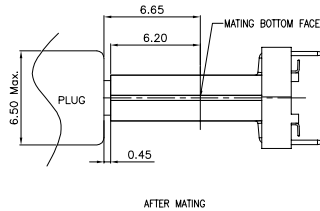
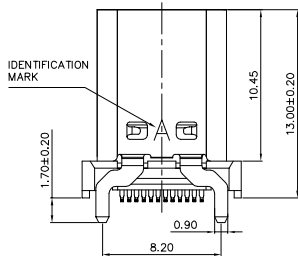

AFTER MATING

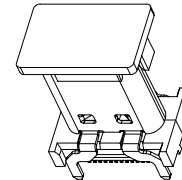

WITH COVER

| PIN NUMBER | SIGNAL NAME | PIN NUMBER | SIGNAL NAME |
|------------|-------------|------------|-------------|
| A1 | GND | B12 | GND |
| A2 | SSTXp1 | B11 | SSRXp1 |
| A3 | SSTXn1 | B10 | SSRXn1 |
| A4 | Vbus | B9 | Vbus |
| A5 | CC1 | B8 | SBU2 |
| A6 | Dp1 | B7 | Dn2 |
| A7 | Dn1 | B6 | Dp2 |
| A8 | SBU1 | B5 | CC2 |
| A9 | Vbus | B4 | Vbus |
| A10 | SSRXn2 | B3 | SSTXn2 |
| A11 | SSRXp2 | B2 | SSTXp2 |
| A12 | GND | B1 | GND |

E

F

| Item | Title | Material | Dispose | Q'TY |
|------|---------------|-----------|---|------|
| 1 | Shell | SUS304 | Ni:30u" Min. | 1PCS |
| 2 | GND Plate | SUS301 | | 2PCS |
| 3 | Mid Plate | SUS301 | | 1PCS |
| 4 | Contact | C7025 | Mating Area: Au 1u" Solder Tails: Matt Tin | 2PCS |
| 5 | InsertMolding | LCP E6808 | UL 94V-0 Black | 1PCS |
| 6 | COVER | LCP E6808 | UL 94V-0 Black | 1PCS |

G

RoHS compliant
unit:mm

| Scale | Free |
|-----------|-------|
| TOLERANCE | |
| .X | ±0.30 |
| .XX | ±0.20 |
| .XXX | ±0.10 |
| DIM | TOL |
| X.° | ±2° |
| Angle | TOL |

| ① | Drawn | Date | Name |
|-----|--------------|------------|-------|
| | Peter | 04.14.2022 | Peter |
| ld. | modification | Date | Name |



| | |
|---|----------------|
| Description: USB 3.2 Gen 2 Type C SMT/ 24Pin / 180° Angled | |
| ASSMANN WSW-NO. A-USBC-32F2-EG-KSR05 | |
| Drawing-No. ASS 9365 CO | rev00 |
| Customer-No. | SHEET 1 / 1 |

H

1

2

3

4

5

6

7